



**6000 SERIES, SLIDING PATIO DOOR,  
NON-IMPACT RESISTANT,  
BYPASS AND EXTERIOR POCKET,  
2, 3 & 4 TRACK CONFIGURATIONS  
MODELS 6200, 6300, 6400 & 6500**



**GENERAL NOTES:**

- 1) THIS PRODUCT HAS BEEN EVALUATED AND IS IN COMPLIANCE WITH THE FLORIDA BUILDING CODE (FBC) INCLUDING THE "HIGH VELOCITY HURRICANE ZONE" (HVHZ). SEE FL31714.
- 2) PRODUCT ANCHORS SHALL BE AS LISTED AND SPACED AS SHOWN ON DETAILS. ANCHOR EMBEDMENT TO BASE MATERIAL SHALL BE BEYOND WALL DRESSING OR STUCCO.
- 3) WHEN USED IN AREAS REQUIRING WIND BORNE DEBRIS PROTECTION, THIS PRODUCT IS REQUIRED TO BE PROTECTED WITH AN IMPACT RESISTANT COVERING THAT COMPLIES WITH FBC SECTIONS 1609.1.2, R301.2.1.2 AND 1626 (HVHZ).
- 4) FOR 2X STUD FRAMING CONSTRUCTION, ANCHORING OF THESE UNITS SHALL BE THE SAME AS THAT SHOWN FOR 2X BUCK MASONRY CONSTRUCTION. 1X BUCKS ARE OPTIONAL, IF USED, INSTALLATION ANCHORS WILL GO THRU THE 1X INTO THE MASONRY CONSTRUCTION. CAN INSTALL DIRECTLY INTO MASONRY WITH A 1/4" MAX SHIM.
- 5) SITE CONDITIONS THAT DEVIATE FROM THE DETAILS OF THIS DRAWING REQUIRE FURTHER ENGINEERING ANALYSIS BY A LICENSED ENGINEER OR REGISTERED ARCHITECT.

TABLE 1: DESIGN PRESSURES

		Design Pressure (+/- psf)													
Frame Height	DLO Height	DLO Width													
		33.855		39.855		43.855		46.200		47.855		49.855		51.855	
80.000	67.825	60.0	-82.8	55.5	-76.3	53.1	-73.1	51.8	-71.2	51.2	-70.5	50.4	-69.4	49.7	-68.4
84.000	71.825	56.4	-77.5	51.8	-71.2	49.5	-68.0	48.1	-66.2	47.6	-65.4	46.8	-64.3	46.1	-63.3
88.000	75.825	53.0	-72.9	48.6	-66.8	46.3	-63.6	44.9	-61.8	44.4	-61.1	43.6	-60.0		
92.000	79.825	50.0	-68.8	45.7	-62.9	43.5	-59.8	42.2	-58.0	41.6	-57.2				
95.500	83.325	47.7	-65.6	43.5	-59.8	41.3	-56.8	40.0	-55.0						

IF WATER INFILTRATION RESISTANCE IS NOT REQUIRED OR OVERHANG IS PER FIG 1, A SILL RISER IS NOT REQUIRED.

TABLE 3: INSTALLATION ANCHORS

Anchor Type	Substrate	Min. Embedment	Min. Edge Distance	Min. On Center
#10 SMS	Wood	1-3/8"	1-1/8"	1"
	Steel Stud	.056"	5/8"	1"
1/4" DeWalt Ultracon+	Concrete/CMU	1-3/8"	1"	4"
	Hollow Block	1-1/4"	1"	3"

**ANCHOR NOTES:**

- 1) CONCRETE ANCHOR LOCATIONS AT THE CORNERS MAY BE ADJUSTED TO MAINTAIN THE MINIMUM EDGE DISTANCE TO MORTOR JOINTS.
- 2) CONCRETE ANCHOR LOCATIONS NOTED AS "MAX. ON CENTER" MUST BE ADJUSTED TO MAINTAIN THE MINIMUM EDGE DISTANCE TO MORTOR JOINTS, ADDITIONAL CONCRETE ANCHORS MAY BE REQUIRED TO ENSURE THE "MAX. ON CENTER" DIMENSION IS NOT EXCEEDED.
- 3) SHEET METAL SCREWS MUST PENETRATE A MIN. OF 3 THREADS THRU THE STEEL STUD.

TABLE 2: SILL RISER POS. (+) DP

Water-Limited (+) Design Pressure		
Sill Riser	Sill Height	Max. (+) DP Allowed
None	1.688"	See Note B
Standard	2.81"	+50.0 psf
High Dam	4"	+60.0 psf

**NOTES:**

- A) IF WATER INFILTRATION RESISTANCE IS REQUIRED, THE LESSER VALUES OF EITHER TABLE 1 AND TABLE 2 DETERMINES THE WATER LIMITED (+) DP.
- B) IF WATER INFILTRATION RESISTANCE IS NOT REQUIRED OR OVERHANG IS PER FIG 1, A SILL RISER IS NOT REQUIRED. IF SO, +DP'S SHOWN IN TABLE 1 MAY BE USED.

FIG 1

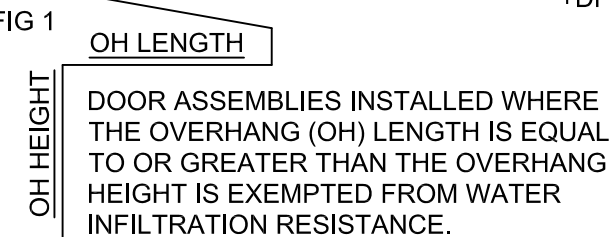

GENERAL NOTES.....	1
DP & ANCHOR TABLES.....	1
CONFIGURATIONS.....	2-3
SIZING TABLE.....	3
SECTION VIEWS.....	4-5
GLAZING DETAILS.....	5
2x BUCK ANCHORAGE.....	6
FRAME ANCHORAGE.....	7-10
EXTRUSIONS.....	11
BILL OF MATERIALS.....	11

BY:	6000 SERIES SLIDING GLASS DOOR	
	GENERAL NOTES, DESIGN PRESSURES, AND ANCHORS	
REVISION:	ADDED 1/8" IG GLASS OPTION	SB
	DELETE ULTRACON, ADD ULTRACON+, REMOVE FBC EDITION, CORRECT TABLE 4, CORRECT STILES REINFORCEMENT, PG 4	
DATE:	12/2022	8/16/23
#:	1	2
DATE:	12/16/2022	
SCALE:	NTS	
BY:	LOGAN YODER	
DRAWING #:	SGD6000-FPA-NI HVHZ	
SHEET:	1 OF 11	

A. LYNN MILLER, P.E., P.E.# 58705  
 1070 TECHNOLOGY DR  
 N. VENICE, FL 34275  
 (941)-480-1600  
 CERT. OF AUTH. #29296  
 COPYRIGHT © 2020  
 NEWSOUTH WINDOW SOLUTIONS  
 LIMITED LICENSE TO MAKE COPIES  
 FOR PERMITTING  
 NEWSOUTH WINDOW SOLUTIONS  
 10741 CROSSROADS COMMERCE BLVD.  
 TAMPA, FL 33610

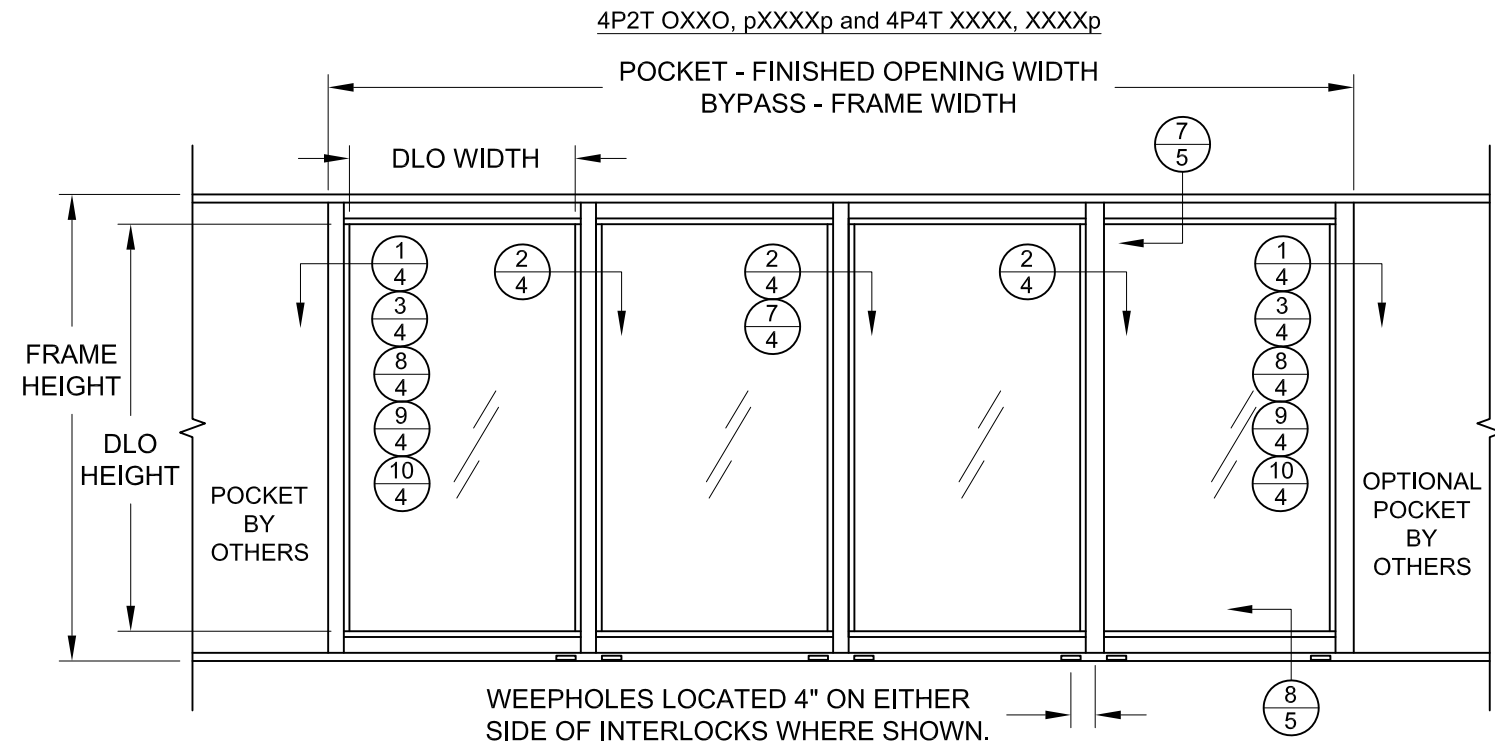
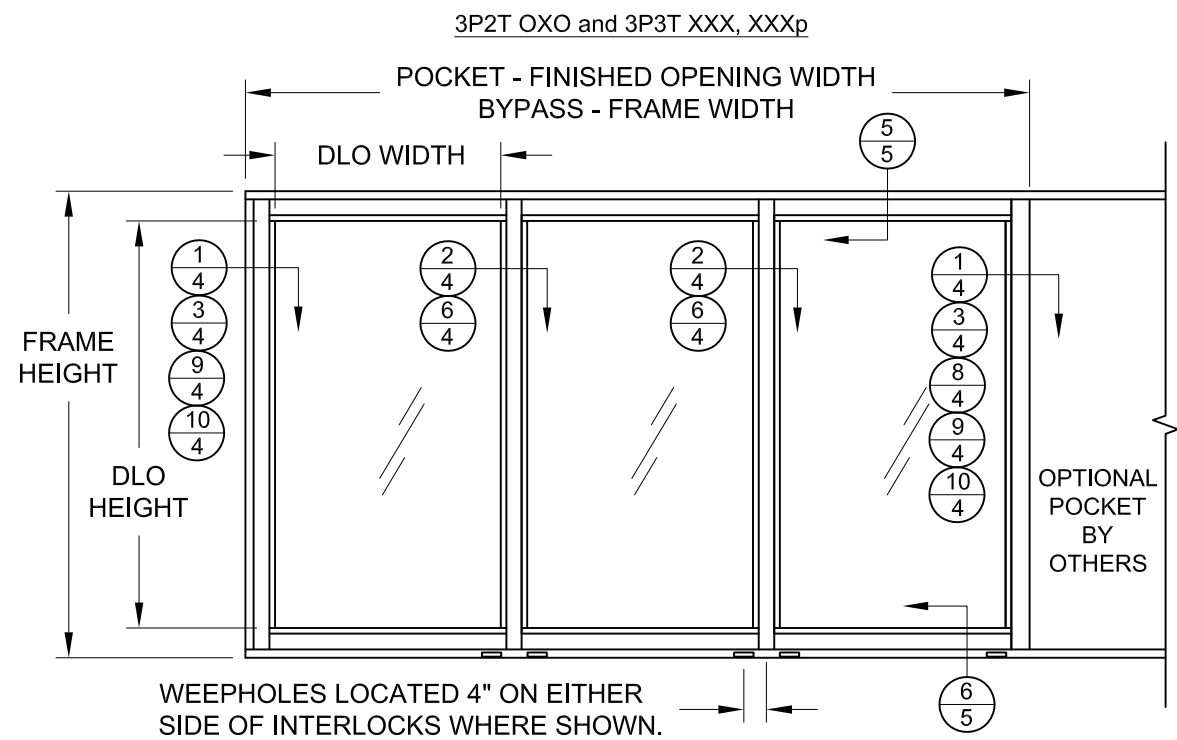
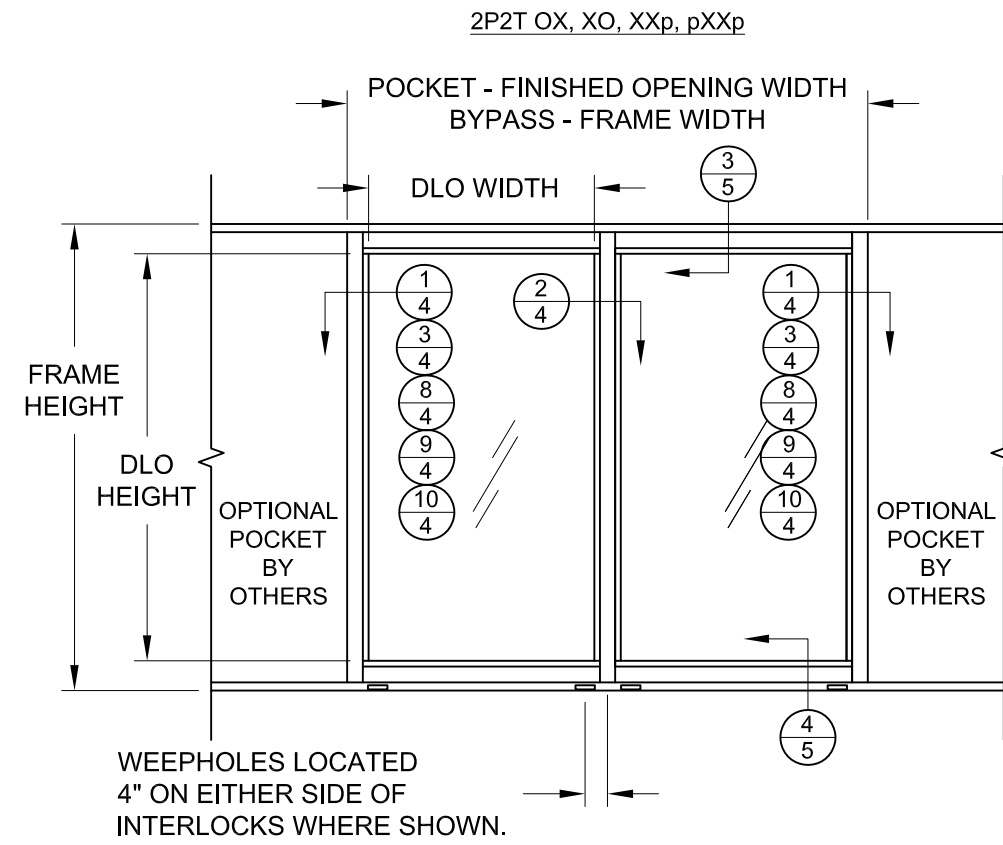
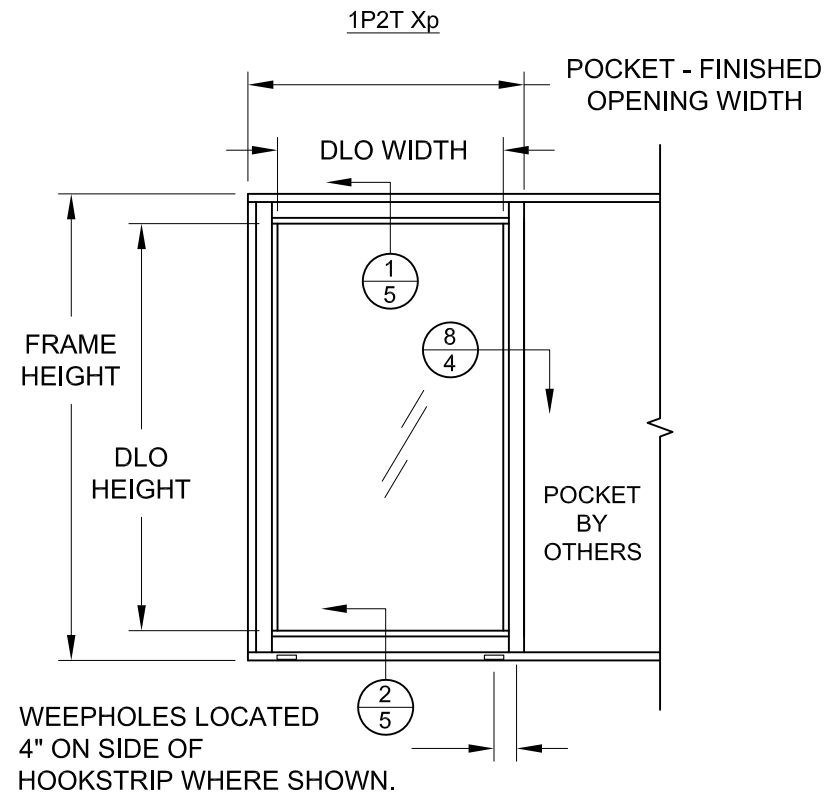
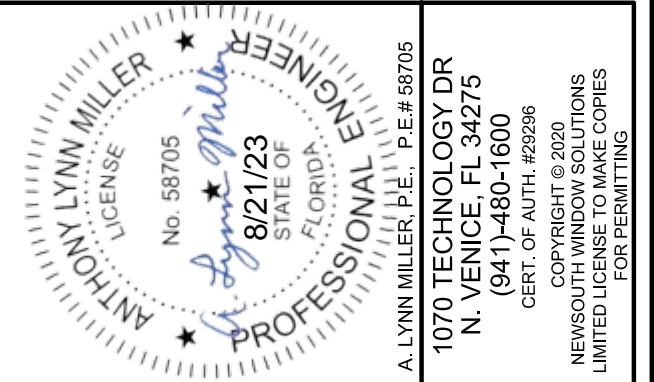

**CONFIGURATION NOTES:**

- 1) SINGLE EXTERIOR POCKET CAN BE EITHER LEFT OR RIGHT.
- 2) POCKET WALL OR CAVITY IS NOT PART OF THIS APPROVAL AND IS TO BE DESIGNED BY OTHERS AND REVIEWED BY THE AUTHORITY HAVING JURISDICTION.

6000 SERIES SLIDING GLASS DOOR	
BY:	SB
REVISION:	ADDED 1/8" IG GLASS OPTION <small>DELETE ULTRACON; ADD ULTRACON+; REMOVE FBC EDITION; CORRECT TABLE 4; CORRECT STILES REINFORCEMENT; PG 4</small>
DATE:	12/2022
#:	1
DATE:	12/16/2022
SCALE:	NTS
BY:	LOGAN YODER
DRAWING #:	SGD6000NI
SHEET:	2 OF 11

A. LYNN MILLER, P.E., P.I.E.# 58705  
 1070 TECHNOLOGY DR  
 N. VENICE, FL 34275  
 (941)-480-1600  
 CERT. OF AUTH. #29296  
 COPYRIGHT © 2020  
 NEWSOUTH WINDOW SOLUTIONS  
 LIMITED LICENSE TO MAKE COPIES  
 FOR PERMITTING

CONFIGURATIONS  
 NEWSOUTH WINDOW SOLUTIONS  
 10741 CROSSROADS COMMERCE BLVD.  
 TAMPA, FL 33610



A. LYNN MILLER, P.E., P.E.# 58705  
 1070 TECHNOLOGY DR  
 N. VENICE, FL 34275  
 (941)-480-1600  
 CERT. OF AUTH. #29296  
 COPYRIGHT © 2020  
 NEWSOUTH WINDOW SOLUTIONS  
 LIMITED LICENSE TO MAKE COPIES  
 FOR PERMITTING

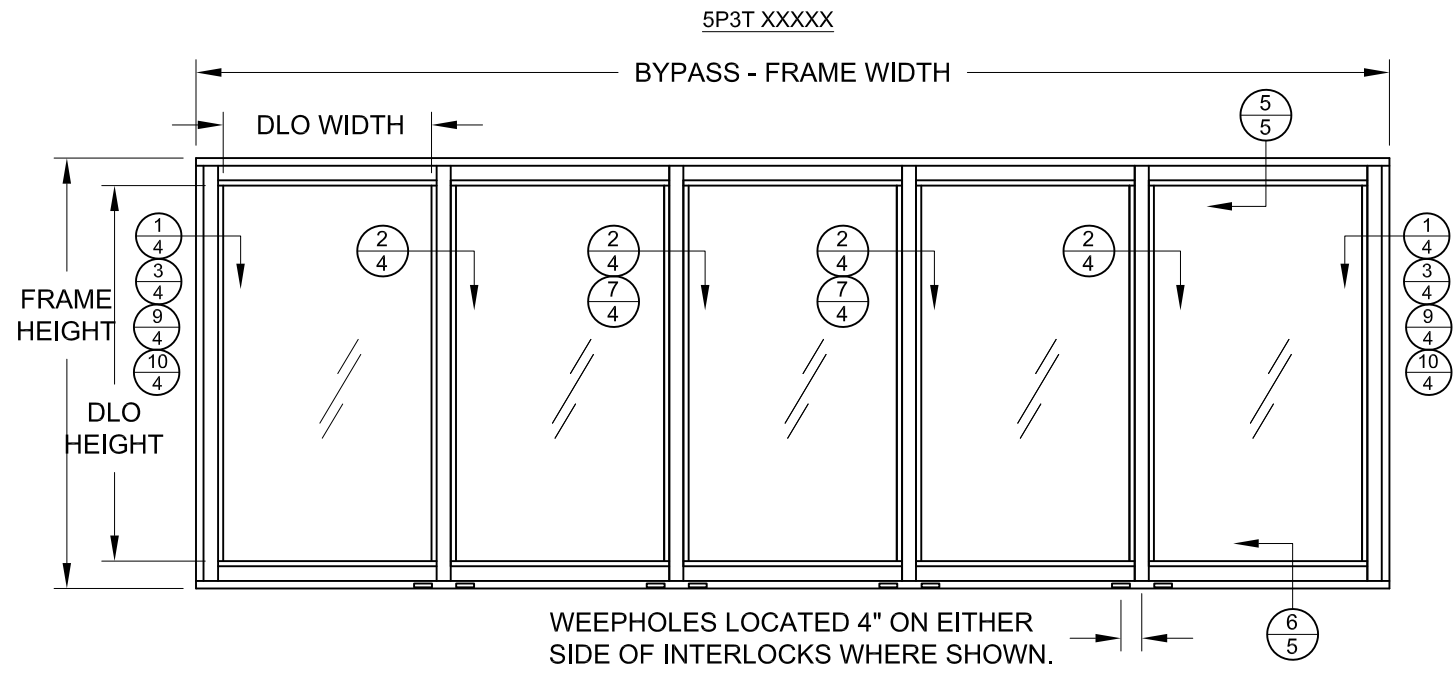
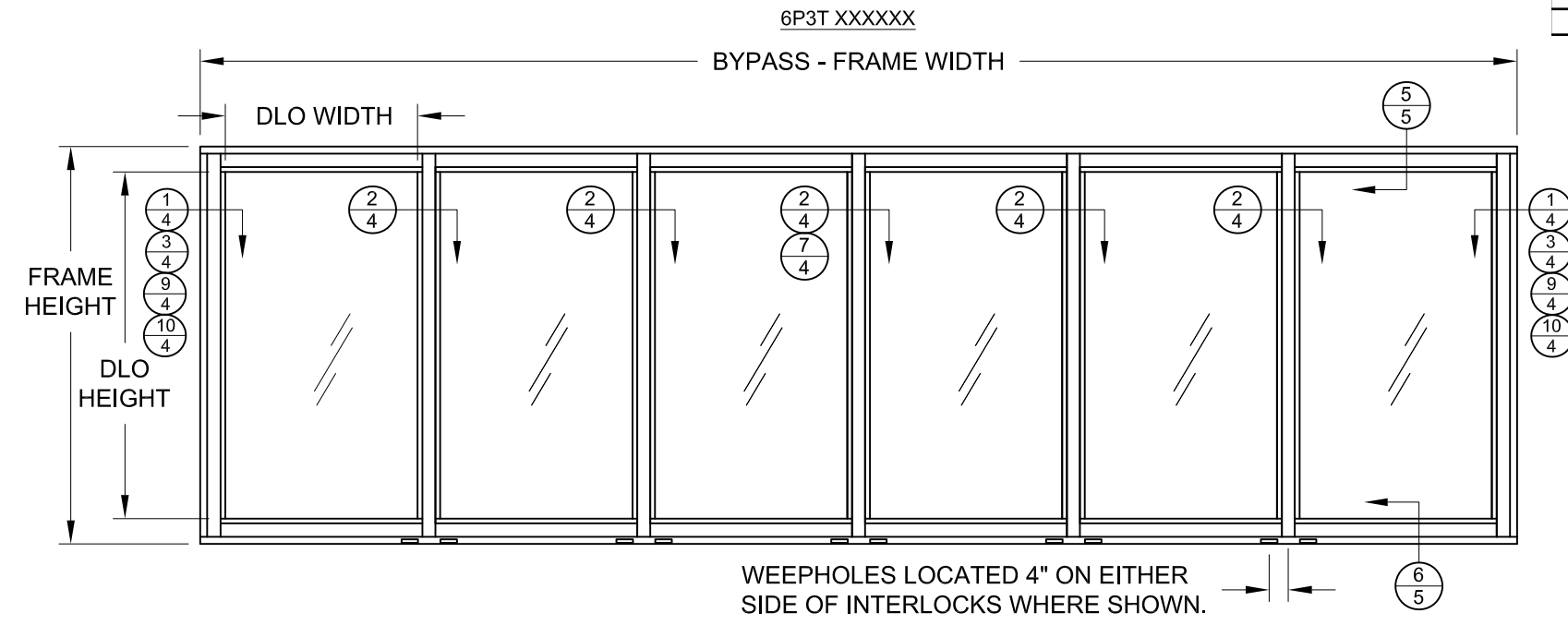

TABLE 4: PANEL DLO, FRAME/FINISHED OPENING WIDTHS

Configuration	Finished Frame Width (in.)						
	DLO Width per Panel (in.)						
1P2T Xp	33.855	39.855	43.855	46.200	47.855	49.855	51.855
2P2T XO, OX	39.030	45.030	49.030	51.375	53.030	55.030	57.030
2P2T XXp	78.37	90.37	98.37	103.06	106.37	110.37	114.37
2P2T pXXp	78.37	90.37	98.37	103.06	106.37	110.37	114.37
3P2T OXO	128.09	146.09	158.09	165.13	170.09	176.09	182.09
3P3T XXX	122.78	140.78	152.78	159.81	164.78	170.78	176.78
3P3T XXXp	117.15	135.15	147.15	154.19	159.15	165.15	171.15
4P2T OXXO	167.12	191.12	207.12	216.50	223.12	231.12	239.12
4P2T pXXXXp	155.93	179.93	195.93	205.31	211.93	219.93	227.93
4P4T XXXX	161.56	185.56	201.56	210.94	217.56	225.56	233.56
4P4T XXXXp	155.93	179.93	195.93	205.31	211.93	219.93	227.93
5P3T XXXXX	206.03	236.03	256.03	267.75	276.03	286.03	296.03
6P3T XXXXXX	244.81	280.81	304.81	318.88	328.81	340.81	352.81



BY: 6000 SERIES SLIDING GLASS DOOR	
CONFIGURATIONS CONT. AND SIZING	
NEWSOUTH WINDOW SOLUTIONS 10741 CROSSROADS COMMERCE BLVD. TAMPA, FL 33610	
REVISION:	BY: SB
DATE:	12/2022
#:	1
DATE:	8/16/23
#:	2
DATE:	12/16/2022
SCALE:	NTS
BY:	LOGAN YODER
DRAWING #:	SGD6000NI
SHEET:	3 OF 11

ADDED 1/8" IG GLASS OPTION  
 DELETE ULTRACON, ADD ULTRACON+, REMOVE  
 FBC EDITION, CORRECT TABLE 4, CORRECT STILES  
 REINFORCEMENT, PG 4



A. LYNN MILLER, P.E., P.I.E.# 58705  
 1070 TECHNOLOGY DR  
 N. VENICE, FL 34275  
 (941)-480-1600  
 CERT. OF AUTH. #29296  
 COPYRIGHT © 2020  
 NEWSOUTH WINDOW SOLUTIONS  
 LIMITED LICENSE TO MAKE COPIES  
 FOR PERMITTING

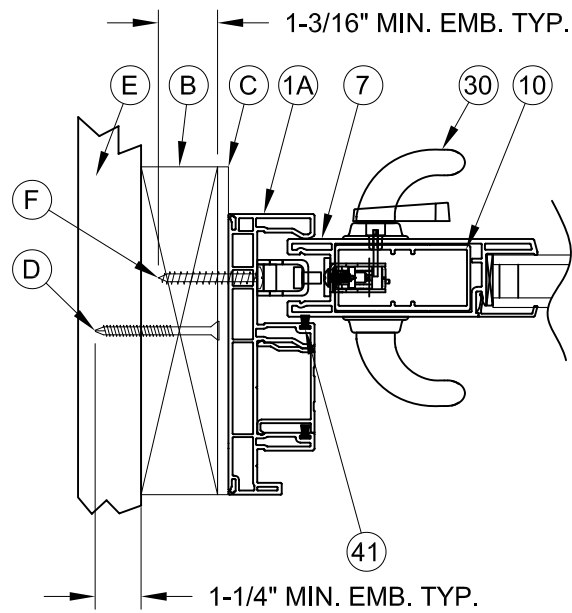

1 HORIZONTAL CROSS SECTION  
 4 2X BUCK CONSTRUCTION

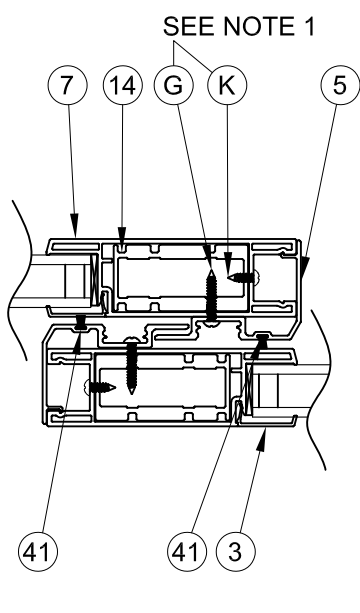

2 HORIZONTAL CROSS SECTION  
 4 INTERLOCK

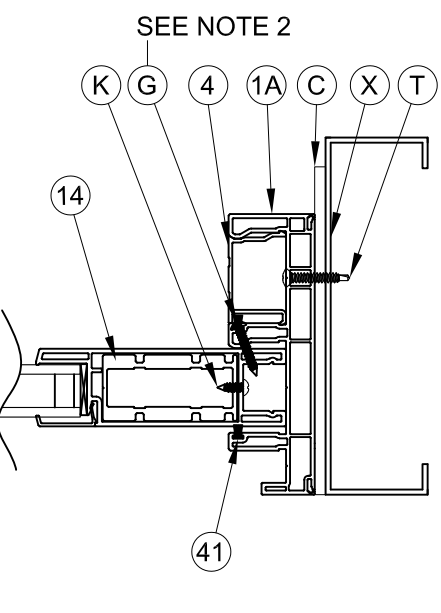

3 HORIZONTAL CROSS SECTION  
 4 STEEL STUD CONSTRUCTION  
 SEE NOTE 5

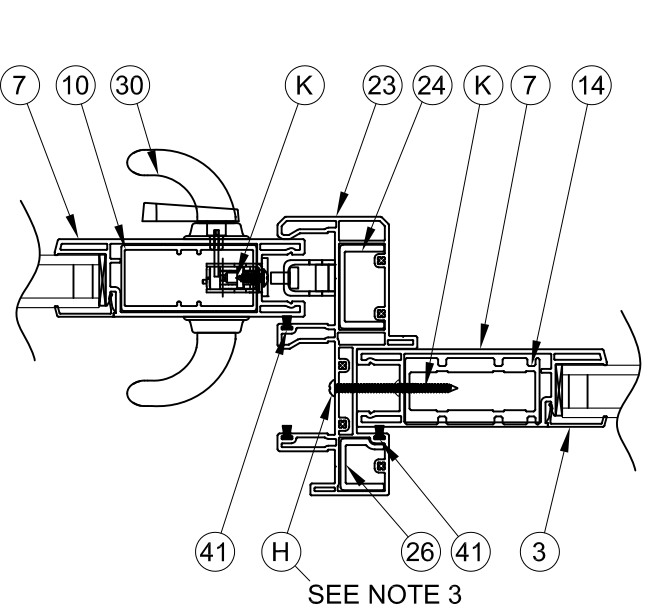

6 HORIZONTAL CROSS SECTION  
 4 MULLION (OFFSET BUTTSTILE)

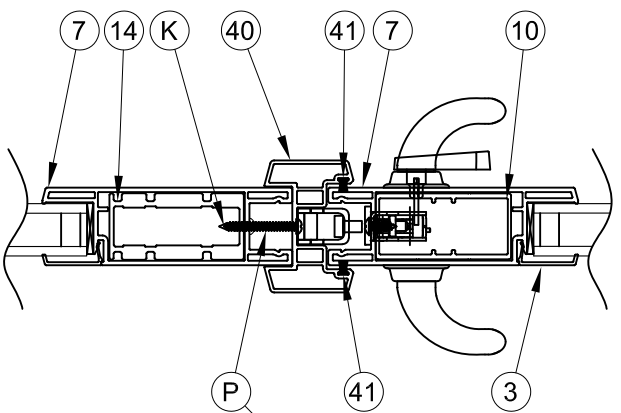

7 HORIZONTAL CROSS SECTION  
 4 ASTRAGAL

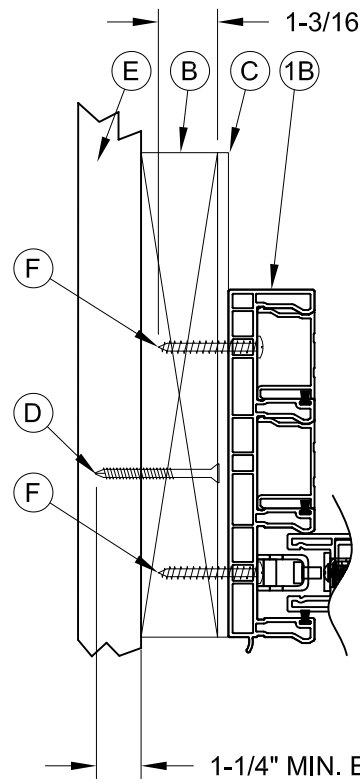

4 HORIZONTAL CROSS SECTION  
 4 2X BUCK CONSTRUCTION

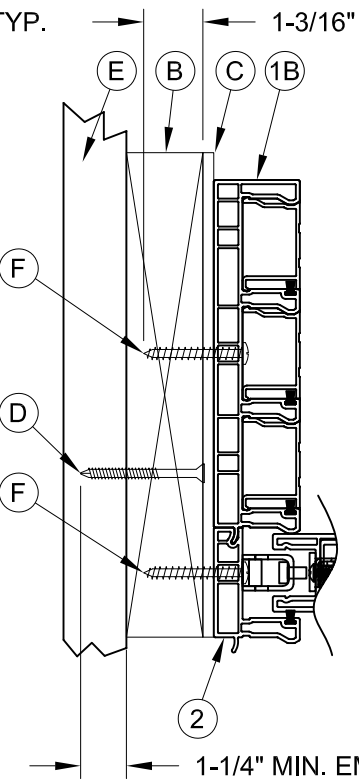

5 HORIZONTAL CROSS SECTION  
 4 2X BUCK CONSTRUCTION

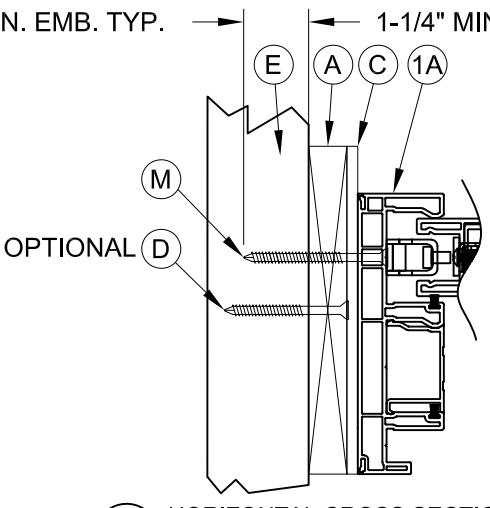

9 HORIZONTAL CROSS SECTION  
 4 1X BUCK CONSTRUCTION  
 SEE NOTE 4

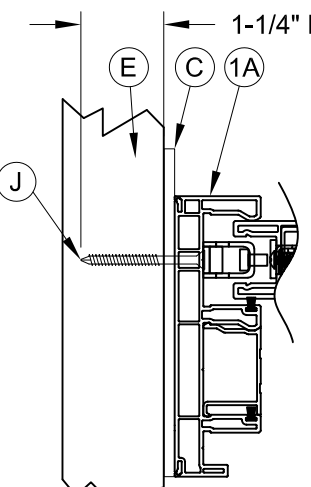

10 HORIZONTAL CROSS SECTION  
 4 MASONRY CONSTRUCTION  
 SEE NOTE 5

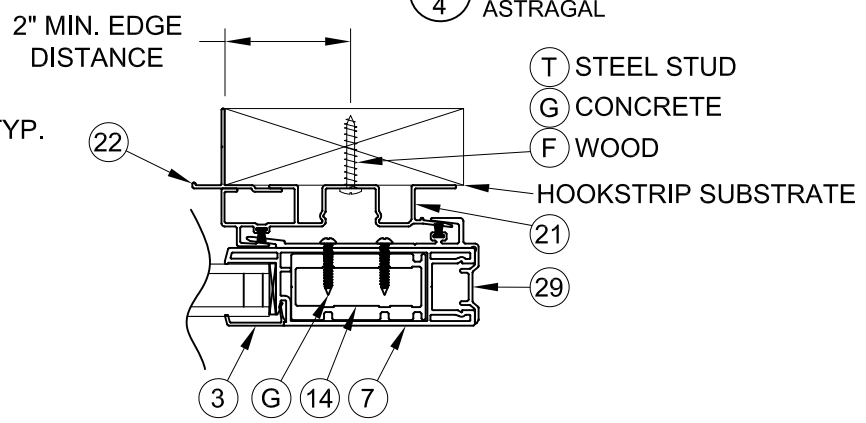

8 HORIZONTAL CROSS SECTION  
 4 HOOKSTRIP

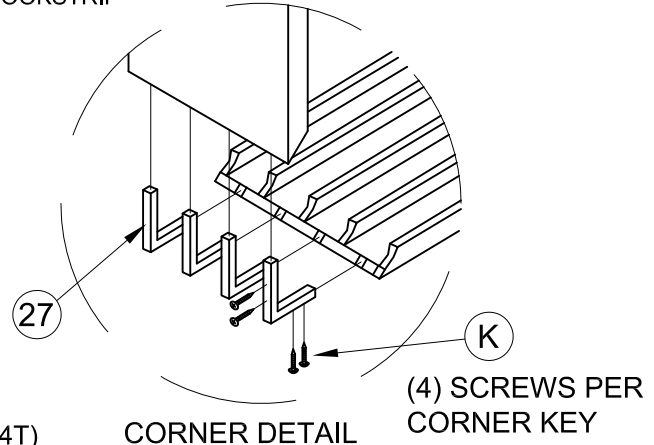

CORNER DETAIL  
 (4) SCREWS PER CORNER KEY

- NOTES:
- INTERLOCK REINFORCEMENT SCREWS, G & K, ARE LOCATED 3" FROM EACH END THEN 14.5" ON CENTER.
  - FIXED PANEL IN JAMB SCREWS, G, ARE LOCATED 8" FROM EACH END AND THEN 4 MORE EQUALLY SPACED (6 TOTAL)
  - FIXED PANEL IN MULLION SCREWS, H, AND FIXED PANEL IN ASTRAGAL SCREWS, P, ARE LOCATED 6" FROM EACH END AND THEN 12" ON CENTER.
  - FOR INSTALLATION INTO 1X BUCK CONSTRUCTION, BUCK TO CONCRETE ANCHORS (IF USED) MUST BE AT LEAST 4" FROM PRODUCT INSTALLATION ANCHORS THRU 1X BUCK INTO MASONRY AND FOLLOW MASONRY ANCHOR REQUIREMENTS FROM TABLE 3. APPLIES TO ALL FRAMES.
  - STEEL STUD AND DIRECT TO MASONRY APPLIES TO ALL FRAMES - SEE SECTIONS ABOVE AND SHEETS 7-10 FOR ANCHORAGE FOR EACH FRAME TYPE. (2T, 3T, 4T)

6000 SERIES SLIDING GLASS DOOR	
HORIZONTAL SECTIONS, CORNER KEY DETAIL	
NEWSOUTH WINDOW SOLUTIONS 10741 CROSSROADS COMMERCE BLVD. TAMPA, FL 33610	
BY:	SB
REVISION:	ADDED 1/8" IG GLASS OPTION DELETE ULTRACON, ADD ULTRACON+, REMOVE FBC EDITION, CORRECT TABLE 4, CORRECT STILES REINFORCEMENT, PG 4
DATE:	12/2022
#:	1
DATE:	8/16/23
#:	2
DATE:	12/16/2022
SCALE:	NTS
BY:	LOGAN YODER
DRAWING #:	SGD6000NI
SHEET:	4 OF 11





A. LYNN MILLER, P.E., P.E.# 58705  
 1070 TECHNOLOGY DR  
 N. VENICE, FL 34275  
 (941)-480-1600  
 CERT. OF AUTH. #29296  
 COPYRIGHT © 2020  
 NEWSOUTH WINDOW SOLUTIONS  
 LIMITED LICENSE TO MAKE COPIES  
 FOR PERMITTING

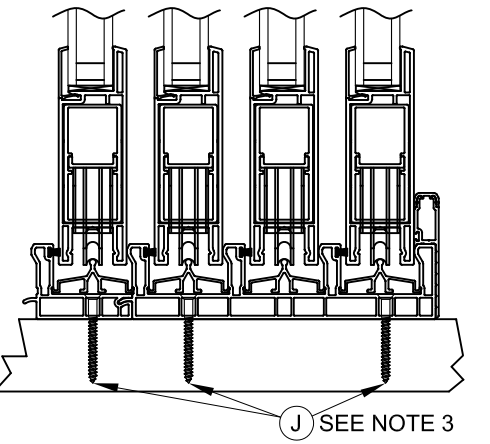
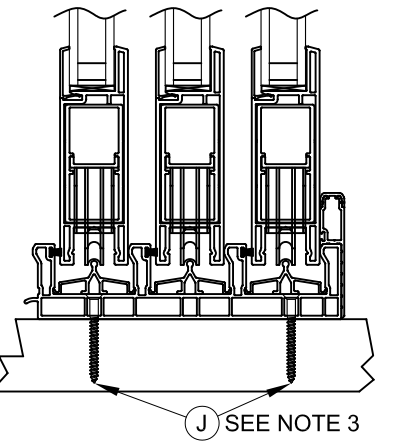
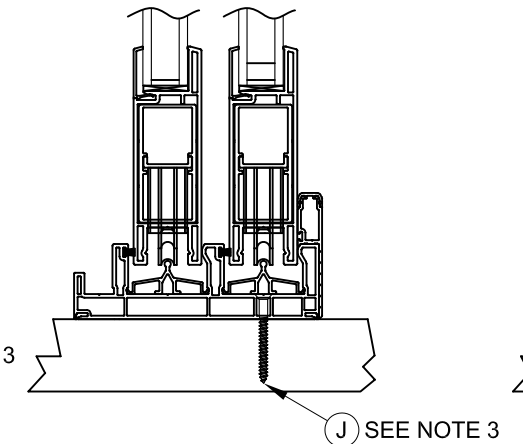
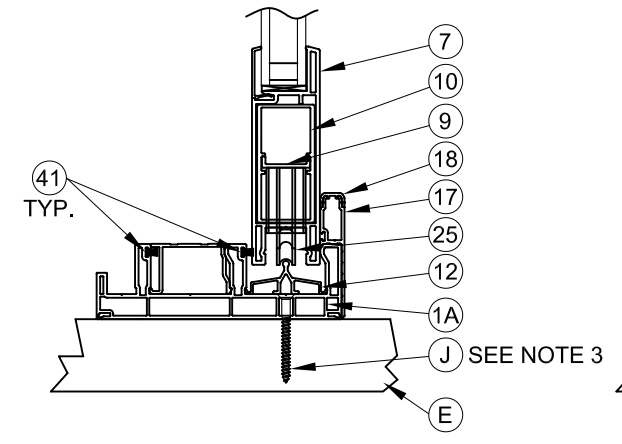
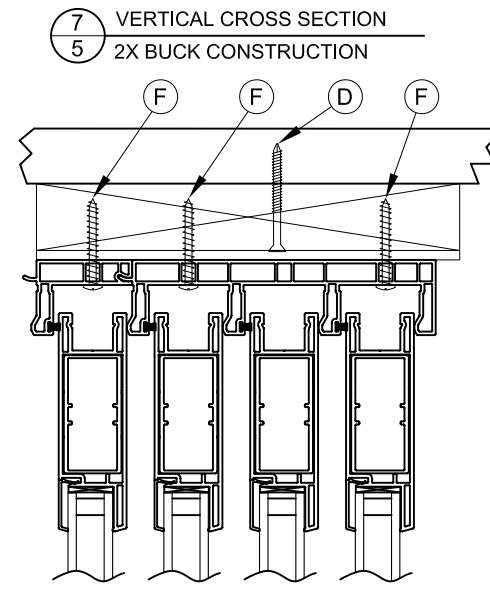
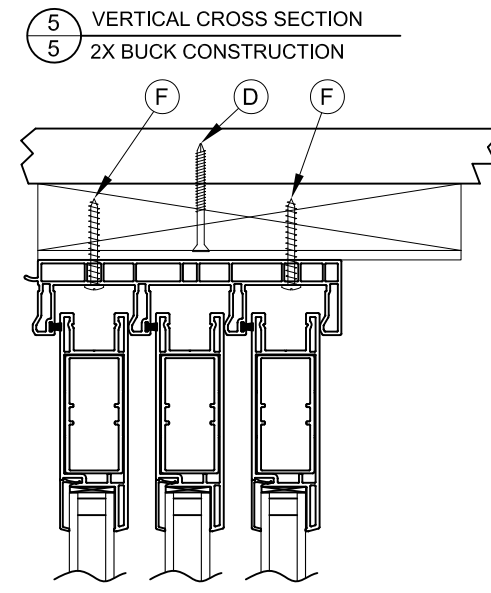
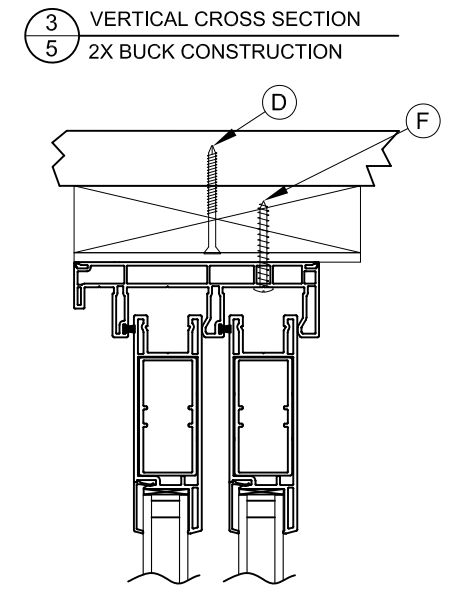
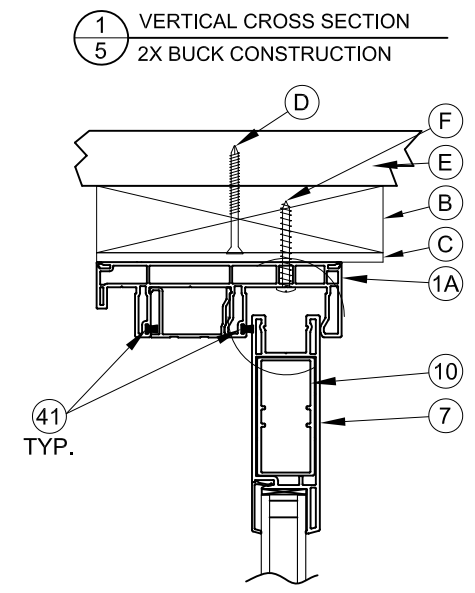
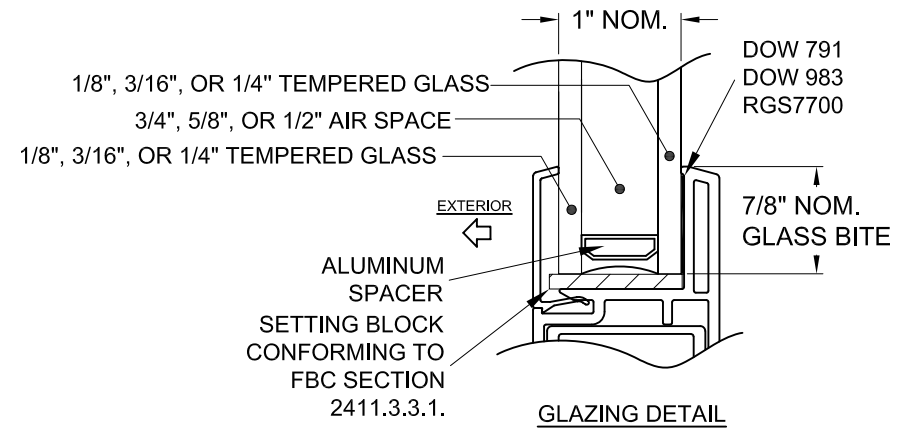

**NOTES:**

- 1) FIXED PANEL SCREW INTO HEAD AND SILL, G, LOCATED 3" AND 6" FROM JAMB AND THEN 6", 9" AND 12" FROM THE INTERLOCK.
- 2) FLAT HEAD ANCHORS MUST BE USED IN SILL, ALL OTHERS INTERFERE WITH ROLLER TRACK.
- 3) FOR INSTALLATION INTO 1X BUCK CONSTRUCTION, BUCK TO CONCRETE ANCHORS (IF USED) MUST BE AT LEAST 4" FROM PRODUCT INSTALLATION ANCHORS THRU 1X BUCK INTO MASONRY AND FOLLOW MASONRY ANCHOR REQUIREMENTS FROM TABLE 3. APPLIES TO ALL FRAMES.
- 4) DIRECT TO MASONRY APPLIES TO ALL FRAMES.

BY: 6000 SERIES SLIDING GLASS DOOR	
VERTICAL SECTIONS, GLAZING DETAIL	
NEWSOUTH WINDOW SOLUTIONS 10741 CROSSROADS COMMERCE BLVD. TAMPA, FL 33610	
REVISION:	SB
DATE:	12/2022
#:	1
DATE:	8/16/23
#:	2
DATE:	12/16/2022
SCALE:	NTS
BY:	LOGAN YODER
DRAWING #:	SGD6000NI
SHEET:	5 OF 11



A. LYNN MILLER, P.E., P.I.E.# 58705  
 1070 TECHNOLOGY DR  
 N. VENICE, FL 34275  
 (941)-480-1600  
 CERT. OF AUTH. #29296  
 COPYRIGHT © 2020  
 NEWSOUTH WINDOW SOLUTIONS  
 LIMITED LICENSE TO MAKE COPIES  
 FOR PERMITTING

MASONRY OPENING

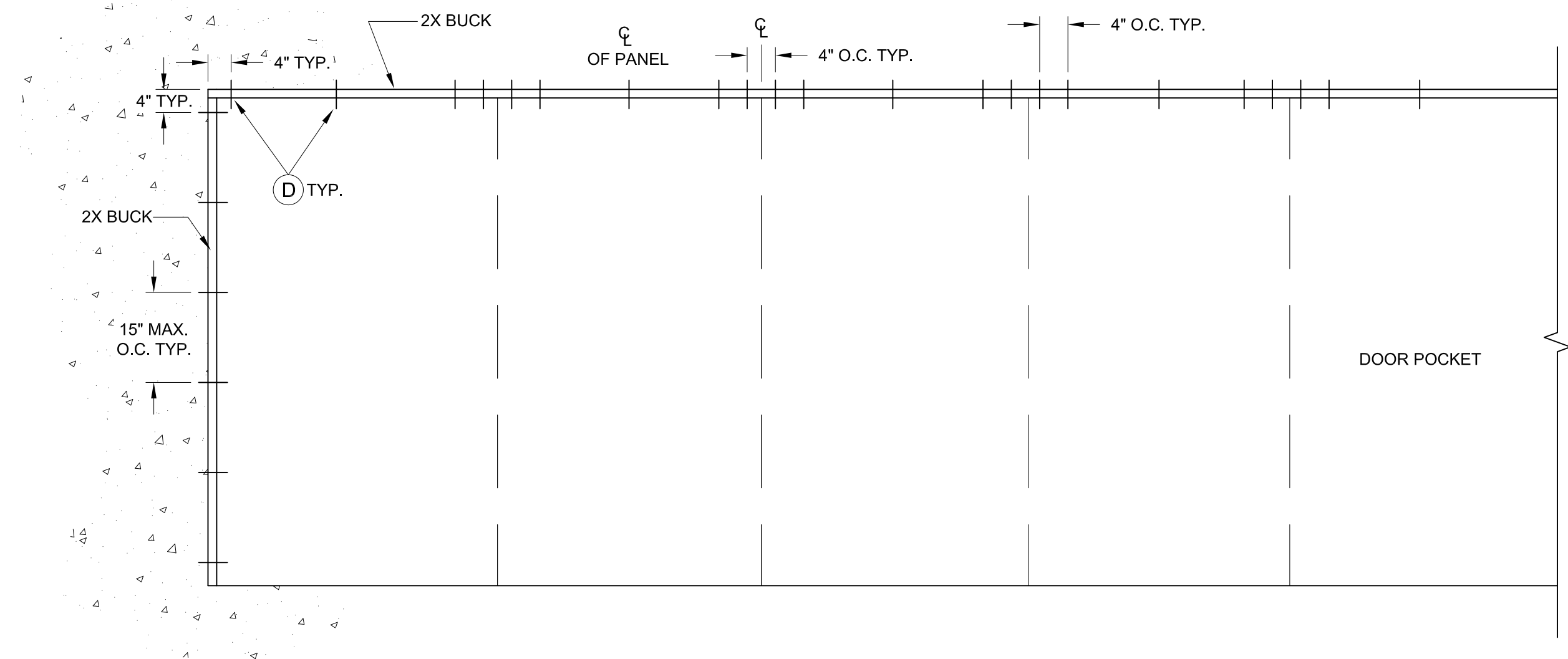

BUCK ANCHORAGE DETAIL

**NOTE:**  
 1) 1X BUCK CONSTRUCTION, BUCK TO CONCRETE ANCHORS (IF USED) MUST BE AT LEAST 4" FROM PRODUCT INSTALLATION ANCHORS THRU 1X BUCK INTO MASONRY AND FOLLOW MASONRY ANCHOR REQUIREMENTS FROM TABLE 3.

BY: 6000 SERIES SLIDING GLASS DOOR	
BUCK ANCHORING	
NEWSOUTH WINDOW SOLUTIONS 10741 CROSSROADS COMMERCE BLVD. TAMPA, FL 33610	
REVISION:	BY: SB
DATE:	12/2022
#:	1
DATE:	8/16/23
#:	2
DATE:	12/16/2022
SCALE:	NTS
BY:	LOGAN YODER
DRAWING #:	SGD6000NI
SHEET:	6 OF 11



A. LYNN MILLER, P.E., P.I.E.# 58705  
 1070 TECHNOLOGY DR  
 N. VENICE, FL 34275  
 (941)-480-1600  
 CERT. OF AUTH. #29296  
 COPYRIGHT © 2020  
 NEWSOUTH WINDOW SOLUTIONS  
 LIMITED LICENSE TO MAKE COPIES  
 FOR PERMITTING

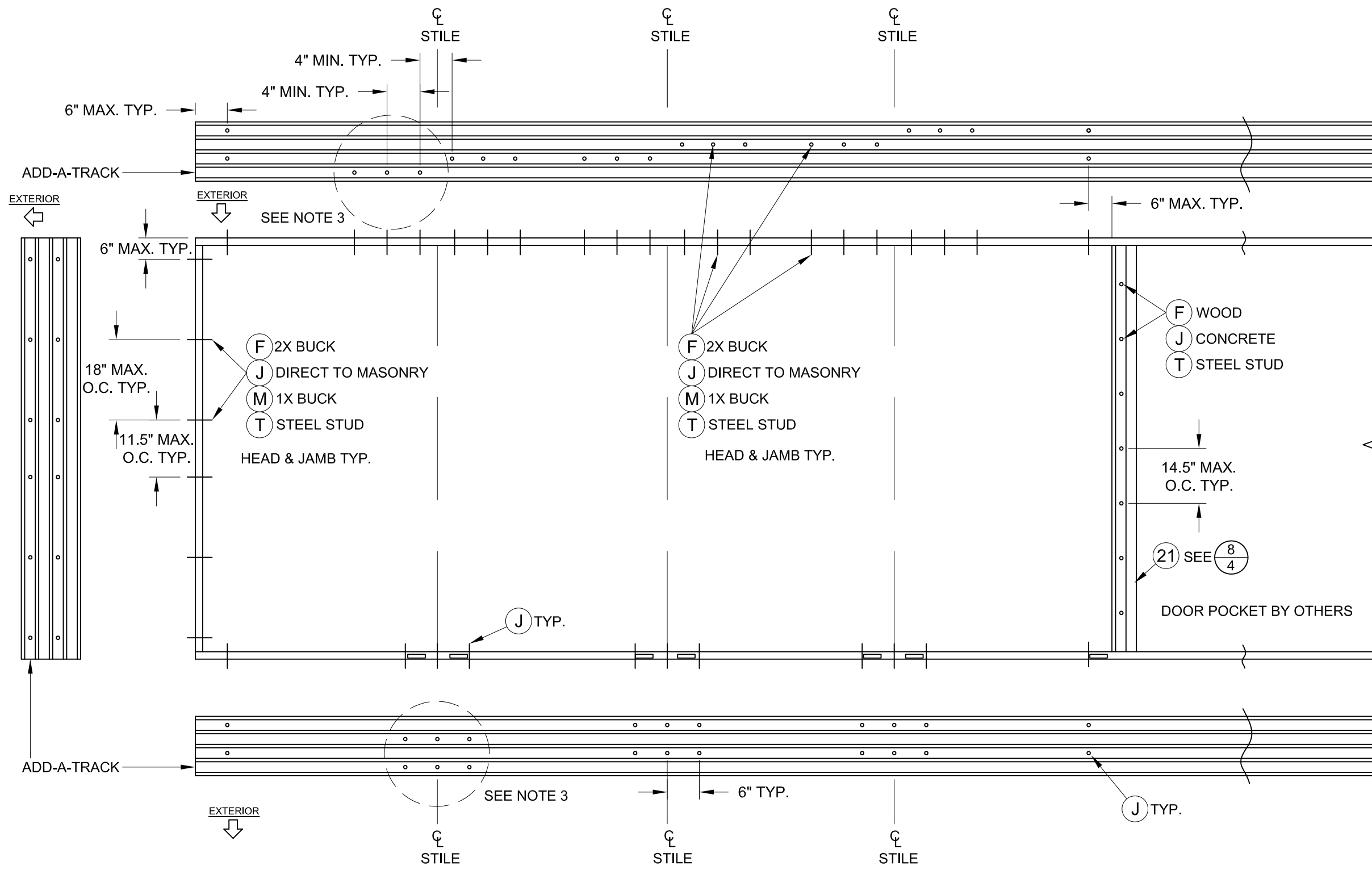

FRAME ANCHORAGE DETAIL  
 4T SLIDING GLASS POCKET DOOR

NOTES:

- 1) STAGGER ANCHORS ABOUT INTERLOCK CENTERLINES - MIN. 4" O.C.
- 2) FOR BYPASS ANCHORAGE, DISMISS THE CLUSTERS NEAR THE POCKET (SHOWN ON RIGHT) AND REPLACE WITH END CLUSTERS (SHOWN ON LEFT)
- 3) CLUSTER ANCHORS MUST GO THRU THE ADD-A-TRACK WHEN THERE IS AN OPERABLE PANEL PRESENT IN THE ADD-A-TRACK.

BY: 6000 SERIES SLIDING GLASS DOOR	
4T FRAME ANCHORING	
NEWSOUTH WINDOW SOLUTIONS 10741 CROSSROADS COMMERCE BLVD. TAMPA, FL 33610	
REVISION:	BY: SB
DATE: 12/2022	ADDED 1/8" IG GLASS OPTION
DATE: 8/16/23	DELETE ULTRACON, ADD ULTRACON+, REMOVE FBC EDITION, CORRECT TABLE 4, CORRECT STILES REINFORCEMENT, PG 4
#: 1	
#: 2	
DATE: 12/16/2022	
SCALE: NTS	
BY: LOGAN YODER	
DRAWING #: SGD6000NI	
SHEET: 7 OF 11	



A. LYNN MILLER, P.E., P.I.E.# 58705  
 1070 TECHNOLOGY DR  
 N. VENICE, FL 34275  
 (941)-480-1600  
 CERT. OF AUTH. #29296  
 COPYRIGHT © 2020  
 NEWSOUTH WINDOW SOLUTIONS  
 LIMITED LICENSE TO MAKE COPIES  
 FOR PERMITTING

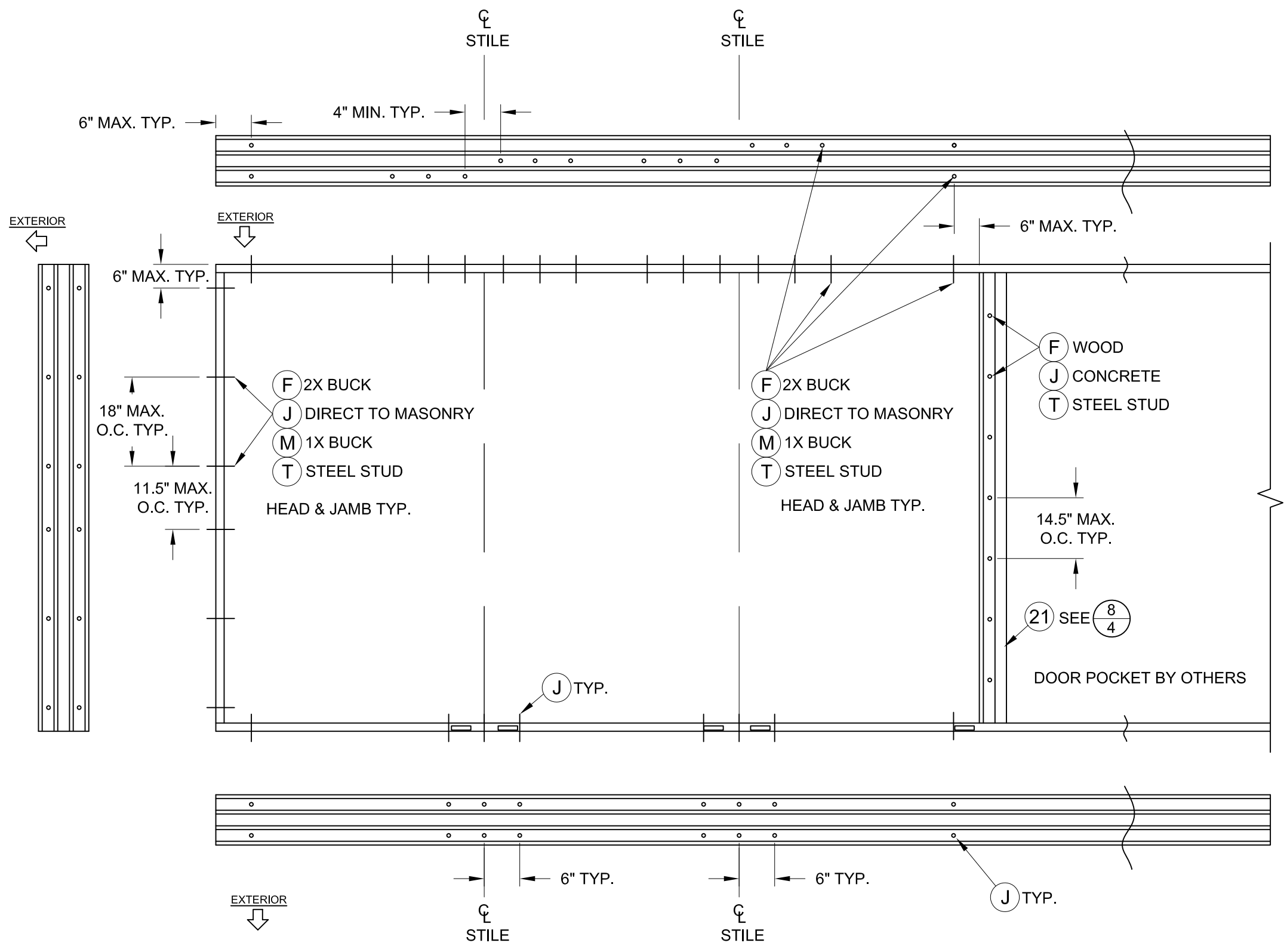

FRAME ANCHORAGE DETAIL  
 3T SLIDING GLASS POCKET DOOR

- NOTES:
- 1) STAGGER ANCHORS ABOUT INTERLOCK CENTERLINES - MIN. 4" O.C.
  - 2) FOR BYPASS ANCHORAGE, DISMISS THE CLUSTERS NEAR THE POCKET (SHOWN ON RIGHT) AND REPLACE WITH END CLUSTERS (SHOWN ON LEFT)

BY: 6000 SERIES SLIDING GLASS DOOR	
3T FRAME ANCHORING	
NEWSOUTH WINDOW SOLUTIONS 10741 CROSSROADS COMMERCE BLVD. TAMPA, FL 33610	
REVISION:	BY: SB
DATE: 12/2022	ADDED 1/8" T IG GLASS OPTION
DATE: 8/16/23	DELETE ULTRACON; ADD ULTRACON+; REMOVE FBC EDITION; CORRECT TABLE 4; CORRECT STILES REINFORCEMENT; PG 4
#:	1
#:	2
DATE: 12/16/2022	
SCALE: NTS	
BY: LOGAN YODER	
DRAWING #: SGD6000NI	
SHEET: 8 OF 11	





A. LYNN MILLER, P.E., P.I.E.# 58705  
 1070 TECHNOLOGY DR  
 N. VENICE, FL 34275  
 (941)-480-1600  
 CERT. OF AUTH. #29296  
 COPYRIGHT © 2020  
 NEWSOUTH WINDOW SOLUTIONS  
 LIMITED LICENSE TO MAKE COPIES  
 FOR PERMITTING

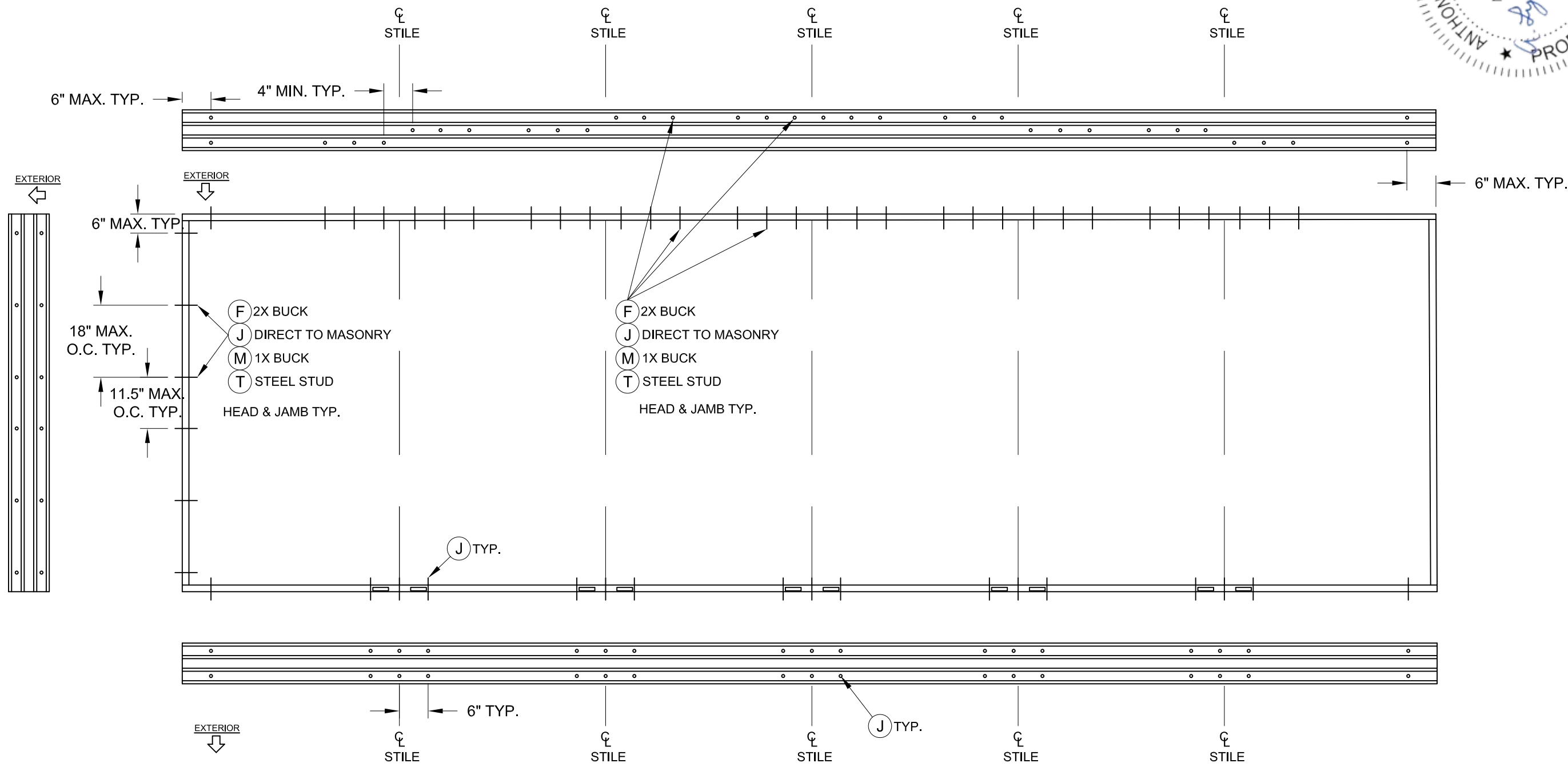

- NOTES:  
 1) STAGGER ANCHORS ABOUT INTERLOCK CENTERLINES - MIN. 4" O.C  
 2) XXXXXX SHOWN, ANCHORAGE SIMILAR FOR XXXXX AND XXX

FRAME ANCHORAGE DETAIL  
 3T SLIDING GLASS DOOR

BY: 6000 SERIES SLIDING GLASS DOOR	
3T FRAME ANCHORING	
NEWSOUTH WINDOW SOLUTIONS 10741 CROSSROADS COMMERCE BLVD. TAMPA, FL 33610	
REVISION:	BY: SB
DATE:	12/2022
#:	1
ADDED 1/8" T IG GLASS OPTION	DELETED ULTRACON, ADD ULTRACON+, REMOVE FBC EDITION, CORRECT TABLE 4, CORRECT STILES REINFORCEMENT, PG 4
DATE:	8/16/23
#:	2
DATE:	12/16/2022
SCALE:	NTS
BY:	LOGAN YODER
DRAWING #:	SGD6000NI
SHEET:	9 OF 11



A. LYNN MILLER, P.E., P.I.E.# 58705  
 1070 TECHNOLOGY DR  
 N. VENICE, FL 34275  
 (941)-480-1600  
 CERT. OF AUTH. #29296  
 COPYRIGHT © 2020  
 NEWSOUTH WINDOW SOLUTIONS  
 LIMITED LICENSE TO MAKE COPIES  
 FOR PERMITTING

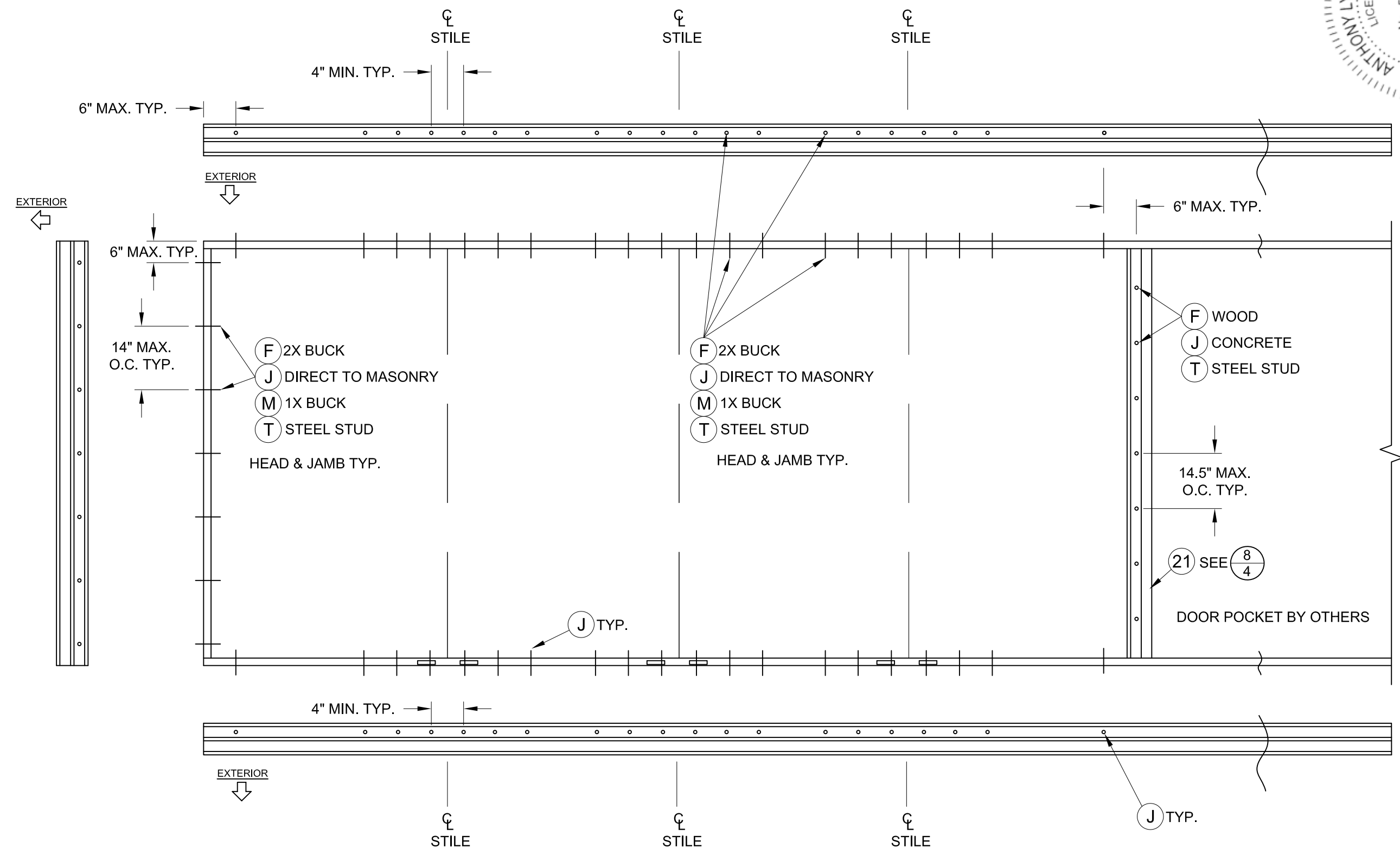

FRAME ANCHORAGE DETAIL  
 2T SLIDING GLASS POCKET DOOR

NOTES:  
 1) FOR BYPASS ANCHORAGE, DISMISS THE CLUSTERS NEAR THE POCKET (SHOWN ON RIGHT) AND REPLACE WITH END CLUSTERS (SHOWN ON LEFT)

BY: 6000 SERIES SLIDING GLASS DOOR	
2T FRAME ANCHORING	
NEWSOUTH WINDOW SOLUTIONS 10741 CROSSROADS COMMERCE BLVD. TAMPA, FL 33610	
REVISION:	BY: SB
DATE: 12/2022	ADDED 1/8" T IG GLASS OPTION
DATE: 8/16/23	DELETE ULTRACON, ADD ULTRACON+, REMOVE FBC EDITION, CORRECT TABLE 4, CORRECT STILES REINFORCEMENT, PG 4
#: 1	
#: 2	
DATE: 12/16/2022	
SCALE: NTS	
BY: LOGAN YODER	
DRAWING #: SGD6000NI	
SHEET: 10 OF 11	

**BILL OF MATERIALS**

ITEM #	DESCRIPTION	MATERIAL
A	1X BUCK (SG>=0.42)	WOOD
B	2X BUCK (SG>=0.42)	WOOD
C	1/4" MAX SHIM SPACE	-
D	1/4" X 2-3/4" ELCO ULTRACON OR ULTRACON+ CONCRETE SCREW	STEEL
E	MASONRY - 3000 PSI MIN CONCRETE CONFORMING TO ACI 301 OR HOLLOW BLOCK CONFORMING TO ASTM C90	CONCRETE
F	#10 X 2" PPH SMS	STEEL
G	#8 X 1" PPH SMS	STEEL
H	#10 X 2-1/2" PPH SMS	STEEL
J	1/4" X 2-1/4" ELCO ULTRACON OR ULTRACON+ CONCRETE SCREW	STEEL
K	#8 X 1/2" PPH SMS	STEEL
N	1/4" X 3-3/4" ELCO ULTRACON OR ULTRACON+ CONCRETE SCREW	STEEL
P	#8 X 1-1/2" PPH SMS	STEEL
T	#10-16 PH SELF-DRILLING SMS (3 THREADS MIN. THRU STUD)	STEEL
X	STEEL STUD MIN THICKNESS 0.056" (ASTM A653 GRADE 50, FY=50 KSI MIN., FU=65 KSI MIN.)	STEEL
1A	FRAME - 2T	PVC
1B	FRAME - 3T	PVC
2	ADD-A-TRACK	PVC
3	GLAZING BEAD	PVC
4	FRAME CAP (JAMB COVER)	PVC
5	INTERLOCK	6063-T5
6	SILL CAP (THRESHOLD)	6063-T5
7	PANEL STILE/RAIL	PVC
9	ROLLER SUPPORT	6063-T5
10	REINFORCEMENT (LOCK STILE, TOP/BTM RAIL)	6065-T5
11	FIXED PANEL SUPPORT	6065-T5
12	ROLLER TRACK	6063-T5
14	HD REINFORCEMENT (INTERLOCK)	ALUM
17	STANDARD SILL RISER	6063-T5
18	SILL RISER CAP	6063-T5
19	HIGH DAM SILL RISER	6063-T5
21	HOOKSTRIP	6063-T5
22	HOOKSTRIP FLANGE	6063-T5
23	MULLION (OFFSET BUTTSTILE)	PVC
24	REINFORCEMENT - MULLION (LARGE)	6063-T5
25	ROLLER ASSEMBLY	STEEL
26	REINFORCEMENT - MULLION (SMALL)	6063-T5
27	CORNER KEY	PVC
29	DOUBLE INTERLOCK (PANEL TO HOOKSTRIP)	6063-T5
30	LOCK AND HANDLE	-
31	STRIKE PLATE	-
39	SCREW COVER (HOOKSTRIP)	PVC
40	ASTRAGAL	6063-T5
41	WTSP, .187 x .290 Poly Fin	
42	WTSP, 0.8125" x 0.875" x 4" Fuzzy Pad (TOP/BTM RAIL)	
43	WTSP, 1.87" x 4" Fuzzy Pad	
44	WTSP, 1.25" x 4" Fuzzy Pad	

THE APPROVED, RIGID PVC EXTERIOR EXTRUSIONS ARE TO BE PRODUCED BY EXTRUDERS' LICENSEES UNDER "AAMA CERTIFICATION PROGRAMS FOR RIGID PVC EXTRUSIONS".

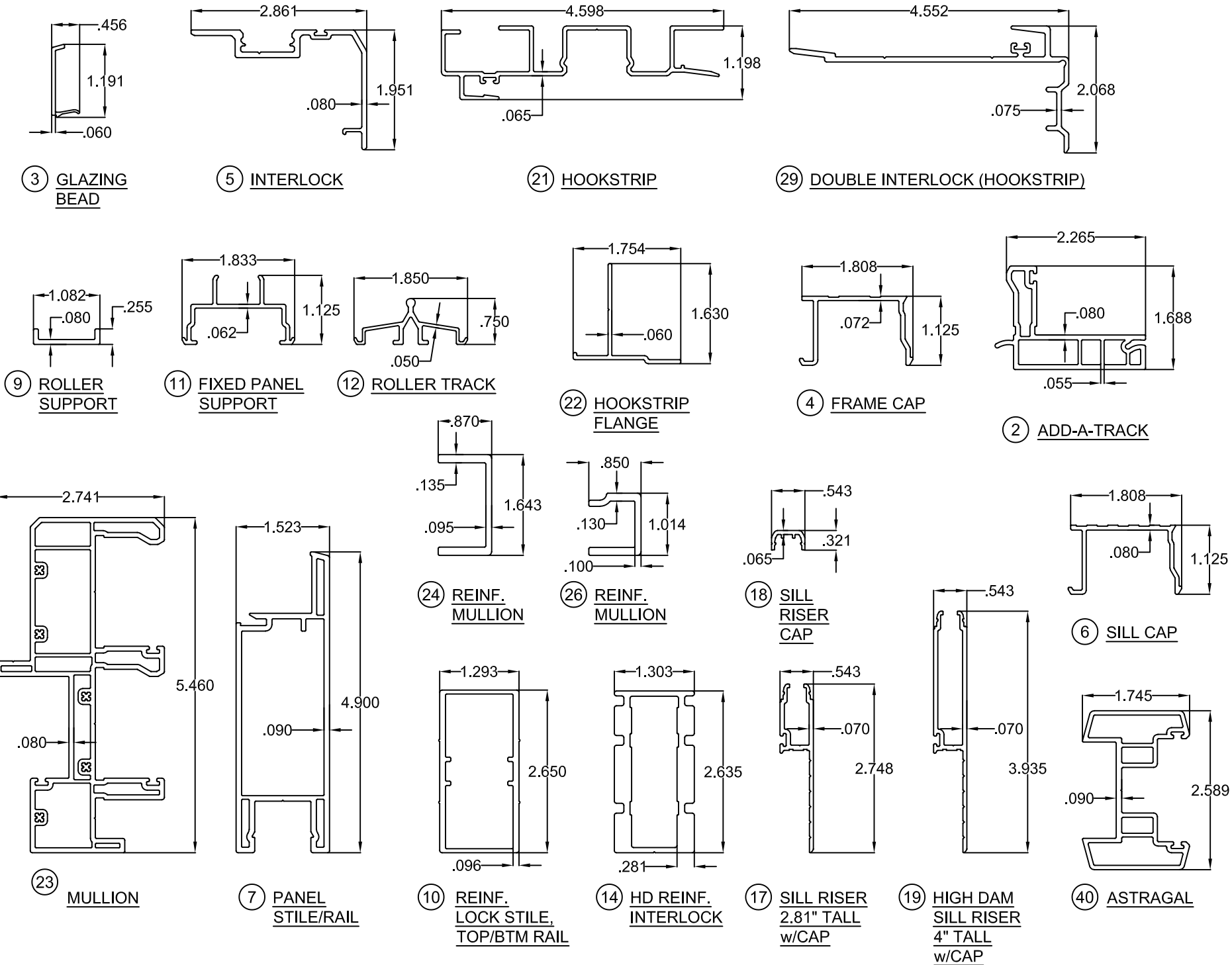
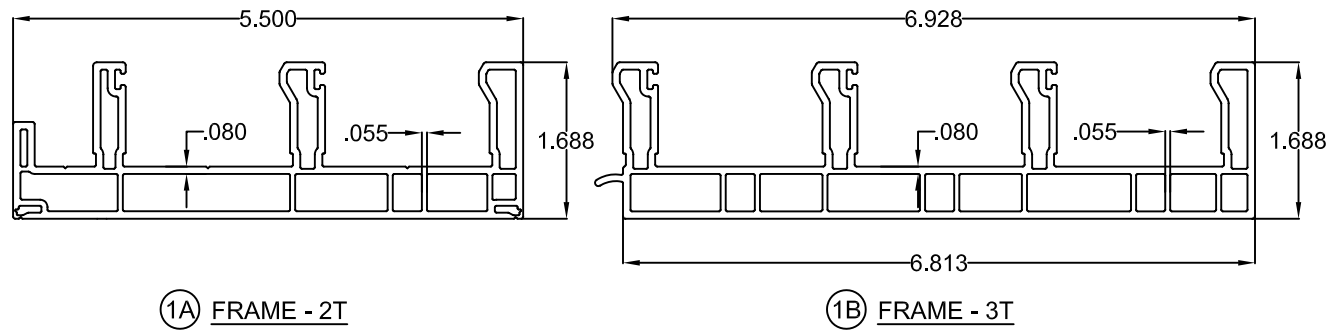

**ANTHONY LYNN MILLER**  
 LICENSE No. 58705  
 8/21/23  
 STATE OF FLORIDA  
 PROFESSIONAL ENGINEER

A. LYNN MILLER, P.E., P.E.# 58705  
 1070 TECHNOLOGY DR  
 N. VENICE, FL 34275  
 (941)-480-1600  
 CERT. OF AUTH. #29296  
 COPYRIGHT © 2020  
 NEWSOUTH WINDOW SOLUTIONS  
 LIMITED LICENSE TO MAKE COPIES  
 FOR PERMITTING

<b>BY:</b> 6000 SERIES SLIDING GLASS DOOR	
EXTRUSIONS / BILL OF MATERIALS	
NEWSOUTH WINDOW SOLUTIONS 10741 CROSSROADS COMMERCE BLVD. TAMPA, FL 33610	
<b>REVISION:</b>	<b>SB</b>
<b>DATE:</b> 12/2022	ADDED 1/8" IG GLASS OPTION
<b>#:</b> 1	DELETE ULTRACON, ADD ULTRACON+, REMOVE FBC EDITION, CORRECT TABLE 4, CORRECT STILES REINFORCEMENT, PG 4
<b>DATE:</b> 8/16/23	
<b>#:</b> 2	
<b>DATE:</b> 12/16/2022	
<b>SCALE:</b> 10:1	
<b>BY:</b> LOGAN YODER	
<b>DRAWING #:</b> SGD6000NI	
<b>SHEET:</b> 11 OF 11	